

Date	Rev. date	Work nr.	Drw. nr.	Rev.
Drawn by Ruukki	Rev.	M27/S05	-	
Scale 1:3	Building		File nr. P2001/003-00039	

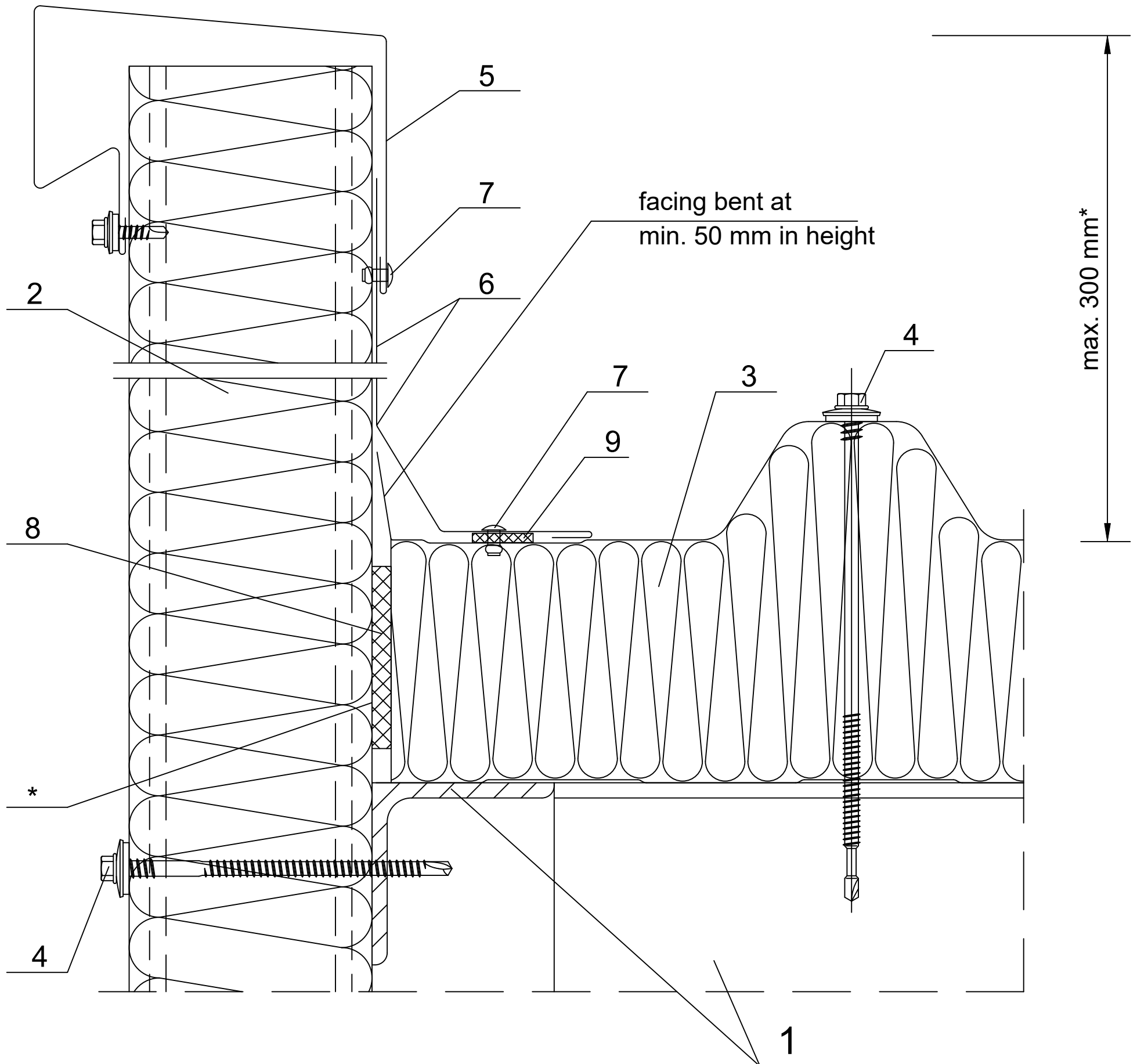

1. Steel elements acc. to engineering design of the structure
2. Ruukki SP2B PIR
3. Ruukki SP2C PIR
4. Panel fastener for hot-rolled sheeting rail or for cold-bent sheeting rail
5. EA1B06 attic flashing
6. Custom ordered flashing
7. Watertight rivet (every 300 mm)
8. Impregnated polyurethane sealant or expanding foam
9. Butyl tape

\* for structures with high requirements regarding thermal insulation facing gap is ~30 mm;  
in this case the maximum support length is 300 mm